

## CLOCK RECEIVERS / MOUVEMENTS

## RIC05-10-20-30-35

These clock receivers are used for the movement of the clock hands of outdoor clocks installed on bell towers, municipal buildings, schools, railway stations etc. They receive impulses from a master cock and transmit it to the clock hands every 60 seconds. Robustly constructed and with an enormous dragging power, they are able to control clock hands on dials between 0,9 and 4 m diameter (2,9 ft-13,1 ft).

Ces mouvements sont utilisés pour commander l'avance des aiguilles de cadrans installés sur les clochers, édifices scolaires et municipaux ou gares. Le récepteur reçoit l'impulsion d'une centrale horaire toutes les minutes et transmet l'avance aux aiguilles. De construction robuste et d'une grande puissance de transmission, les récepteurs font fonctionner les cadrans jusqu'à 4 m de diamètre.

### CLOCK RECEIVER FOR DIAL UP TO 90 CM – RIC05 MOUVEMENT POUR COMMANDE DE CADRANS JUSQU'À 90 CM – RIC05



#### TECHNICAL CHARACTERISTICS

- Diameter dial: max 90 cm (2,9 ft)
- Power: 220-230 VAC, 50/60 Hz, 9,5 W (RIC0504001, RIC0504003); 110/115 VAC, 50/60 Hz, 3,5 W (RIC0504002)
- Torque: 2,45 Nm
- Functioning: minute inversion phase

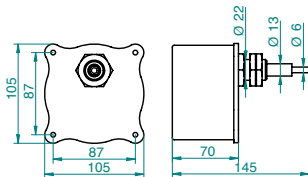

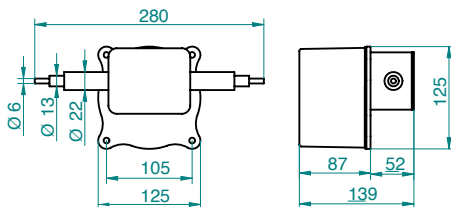

| CODE       | DESCRIPTION                                  |
|------------|--|
| RIC0504001 | CLOCK MOVEMENT MAX 90CM BUSH 25MM            |
| RIC0504002 | CLOCK MOVEMENT MAX 90CM BUSH 76MM (3IN) 110V |
| RIC0504003 | CLOCK MOVEMENT MAX 90CM BUSH 76MM            |

### 2 OUTPUTS CLOCK RECEIVER FOR DIAL UP TO 90 CM – RIC10 MOUVEMENT POUR COMMANDE DE 2 CADRANS JUSQU'À 90 CM – RIC10



#### TECHNICAL CHARACTERISTICS

- Diameter dial: max 90 cm (2,9 ft)
- Outputs: 2 parallel
- Power: 220-230 VAC, 50/60 Hz, 9,5 W (RIC1004023-24-25); 110/115 VAC, 50/60 Hz, 3,5 W (RIC1004015-16-17)
- Torque: 2,94 Nm
- Functioning: minute inversion phase

| CODE   | DESCRIPTION  |
|--|--|
| RIC1004015  | CLOCK MOVEMENT MAX 90CM BUSH 46MM (1.8IN) 2 EXITS 110V |
| RIC1004016  | CLOCK MOVEMENT MAX 90CM BUSH 68MM (2.6IN) 2 EXITS 110V |
| RIC1004017  | CLOCK MOVEMENT MAX 90CM BUSH 81MM (3.1IN) 2 EXITS 110V |
| RIC1004023   | CLOCK MOVEMENT MAX 90CM BUSH 46MM 2 EXITS              |
| RIC1004024   | CLOCK MOVEMENT MAX 90CM BUSH 68MM 2 EXITS              |
| RIC1004025   | CLOCK MOVEMENT MAX 90CM BUSH 81MM 2 EXITS              |

## CLOCK RECEIVERS / MOUVEMENTS

RIC05-10-20-30-35





### CLOCK RECEIVER FOR DIAL UP TO 150 CM – RIC10 MOUVEMENT POUR COMMANDE DE CADRANS JUSQU'À 150 CM – RIC10

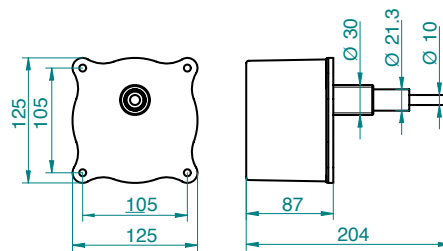

#### TECHNICAL CHARACTERISTICS

- Dial diameter: max 150 cm (4,9 ft)
- Power: 220-230 VAC, 50/60 Hz, 16,7 W (RIC1004003-05-06-07-08-09-10-11-12-13-14-19); 110/115 VAC, 50/60 Hz, 5 W (RIC1004004-20-21-22-27)
- Torque: 4,9 Nm
- Functioning: minute inversion phase



| CODE  | DESCRIPTION  |
|---|--|
| RIC1004003  | CLOCK MOVEMENT MAX 150CM BUSH 35MM                           |
| RIC1004004  us | CLOCK MOVEMENT MAX 150CM BUSH 76MM (3IN) 110V                |
| RIC1004005  | CLOCK MOVEMENT MAX 150CM HOURS SHAFT 300MM                   |
| RIC1004006  | CLOCK MOVEMENT MAX 150CM HOURS SHAFT 300MM PRT               |
| RIC1004007  | CLOCK MOVEMENT MAX 150CM HOURS SHAFT 600MM                   |
| RIC1004008  | CLOCK MOVEMENT MAX 150CM HOURS SHAFT 600MM PRT               |
| RIC1004009  | CLOCK MOVEMENT MAX 150CM HOURS SHAFT 900MM                   |
| RIC1004010  | CLOCK MOVEMENT MAX 150CM HOURS SHAFT 900MM PRT               |
| RIC1004011  | CLOCK MOVEMENT MAX 150CM HOURS SHAFT 1200MM                  |
| RIC1004012  | CLOCK MOVEMENT MAX 150CM HOURS SHAFT 1200MM PRT              |
| RIC1004013  | CLOCK MOVEMENT MAX 150CM HOURS SHAFT ON REQUEST<1200MM       |
| RIC1004014  | CLOCK MOVEMENT MAX 150CM HOURS SHAFT ON REQUEST<1200MM PRT   |
| RIC1004019  | CLOCK MOVEMENT MAX 150CM BUSH 76MM                           |
| RIC1004020  us | CLOCK MOVEMENT MAX 150CM BUSH 300MM (11.8IN) 110V            |
| RIC1004021  us | CLOCK MOVEMENT MAX 150CM HOURS SHAFT 500 MM(19.6IN) 110V PRT |
| RIC1004022  us | CLOCK MOVEMENT MAX 150CM BUSH 165MM (6.5IN) 110V             |
| RIC1004027  | CLOCK MOVEMENT MAX 150CM H. SHAFT ON REQUEST<1200MM 110V PRT |

## CLOCK RECEIVER FOR DIAL UP TO 400 CM – RIC20

### MOUVEMENT POUR COMMANDE DE CADRANS JUSQU'À 400 CM – RIC20



#### TECHNICAL CHARACTERISTICS

- Dial diameter: max 400 cm (13,1 ft)
- Power: 220-230 VAC, 50/60 Hz, 30 W (RIC2004003-05-06-07-08-10-11-12-13-14-15-21-24); 110/115 VAC, 50/60 Hz, 29,7 W (RIC2004004-09-20-22)
- Torque: 29,4 Nm
- Functioning: minute inversion phase

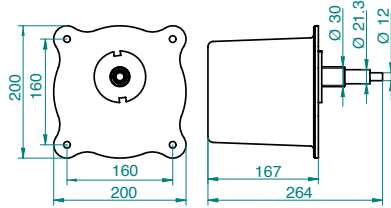

| CODE       | DESCRIPTION  |
|------------|--|
| RIC2004003 | CLOCK MOVEMENT MAX 400CM BUSH 35MM                           |
| RIC2004004 | CLOCK MOVEMENT MAX 400CM BUSH 76MM (3IN) 110V                |
| RIC2004005 | CLOCK MOVEMENT MAX 400CM HOURS SHAFT 300MM                   |
| RIC2004006 | CLOCK MOVEMENT MAX 400CM HOURS SHAFT 300MM PRT               |
| RIC2004007 | CLOCK MOVEMENT MAX 400CM HOURS SHAFT 600MM                   |
| RIC2004008 | CLOCK MOVEMENT MAX 400CM HOURS SHAFT 600MM PRT               |
| RIC2004009 | CLOCK MOVEMENT MAX 400CM HOURS SHAFT 500MM (19,6IN) PRT 110V |
| RIC2004010 | CLOCK MOVEMENT MAX 400CM HOURS SHAFT 900MM                   |
| RIC2004011 | CLOCK MOVEMENT MAX 400CM HOURS SHAFT 900MM PRT               |
| RIC2004012 | CLOCK MOVEMENT MAX 400CM HOURS SHAFT 1200MM                  |
| RIC2004013 | CLOCK MOVEMENT MAX 400CM HOURS SHAFT 1200MM PRT              |
| RIC2004014 | CLOCK MOVEMENT MAX 400CM HOURS SHAFT ON REQUEST<1200MM       |
| RIC2004015 | CLOCK MOVEMENT MAX 400CM HOURS SHAFT ON REQUEST<1200MM PRT   |
| RIC2004020 | CLOCK MOVEMENT MAX 400CM BUSH 300MM (11,8IN) 110V            |
| RIC2004021 | CLOCK MOVEMENT MAX 400CM BUSH 76MM                           |
| RIC2004022 | CLOCK MOVEMENT MAX 400CM BUSH 165MM (6,5IN) 110V             |
| RIC2004024 | CLOCK MOVEMENT MAX 400CM H. SHAFT ON REQUEST<1200MM 110V PRT |

## CLOCK RECEIVER FOR ILLUMINATED HANDS CLOCK – RIC30 MOUVEMENT POUR AIGUILLES LUMINEUSES – RIC30

This kind of clock receiver has been designed for the movement of illuminated hands clock. Indicated for use together with a LED system lighting, but it can be also used with any type of light source. The LED lighting system enables the dial to maintain its' aesthetic characteristics during the day and to offer an excellent level of brightness during the night hours. The materials used are of high quality to ensure optimum efficiency in outdoor environments.

Ce genre de mouvement a été créé spécialement pour la mise en mouvement des aiguilles lumineuses. Le RIC30 est proposé en accouplement avec le système d'éclairage par LED, mais peut être utilisée avec d'autres sources lumineuses adaptées. Le système d'éclairage par LED permet au cadran de maintenir dans la durée ses caractéristiques de départ, d'offrir un excellent niveau de luminosité dans la nuit et d'esthétiques dans la journée. Les matériaux utilisés sont de haute qualité pour assurer une efficacité optimale dans des environnements extérieurs.



### TECHNICAL CHARACTERISTICS

- Case in aluminium, resistant to the weather conditions
- Wheels in bronze
- Pin output in zinc coated iron with ertalyte bushes to protect the electric connection
- Antifriction bearing in teflon
- Electric connection through commutator
- Functioning: minute inversion phase
- Power: 220-230 VAC, 50/60 Hz, 30 W; 110/115 VAC, 50/60 Hz, 29,7 W)
- Torque: 29,4 Nm

### RELATED PRODUCTS – PRODUITS ASSOCIÉS

- NUMERALS NUM6504003 (see pp. 88-90)
- CLOCK HANDS LAN6504002 (see pp. 88-90)

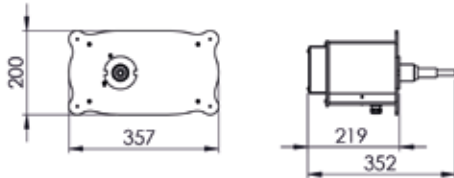

| CODE       | DESCRIPTION   |
|------------|---|
| RIC3004001 | CLOCK MOVEMENT MAX 300CM FOR ILLUMINATED HANDS DIAL       |
| RIC3004003 | CLOCK MOVEMENT MAX 300CM FOR ILLUMINATED HANDS DIAL - RGB |

## SYNCHRONISED MOVEMENT FOR CLOCK DIAL MAX 130 CM – RIC35 MOUVEMENT SYNCHRONE AVEC MINUTERIE POUR CADRAN MAX 130 CM – RIC35

A clock for large indoor clock faces, a perfect feature for public places (bars and restaurants), offices and the home. Ecat Orologi's decades of experience in monumental and industrial clocks is placed at the service of businesses and enters the home. Simple manual hand adjustment.

Horloge pour cadrans d'intérieur de grandes tailles idéale comme complément d'ameublement pour locaux publics (bars et restaurants), bureaux ou habitations privées. L'expérience décennale de Ecat Orologi en horlogerie monumentale et industrielle se met au service des activités commerciales et pénètre entre les murs domestiques. Simple correction manuelle des aiguilles.



### TECHNICAL CHARACTERISTICS

- Case in aluminium, resistant to the weather conditions
- Power: 220-230 VAC, 50/60 Hz, 9,5 W, without power reserve
- Torque 2,45 Nm
- Time correction through manual movement of the hands

### RELATED PRODUCTS – PRODUITS ASSOCIÉS

- Clock hands and numerals (see pp. 88-90)

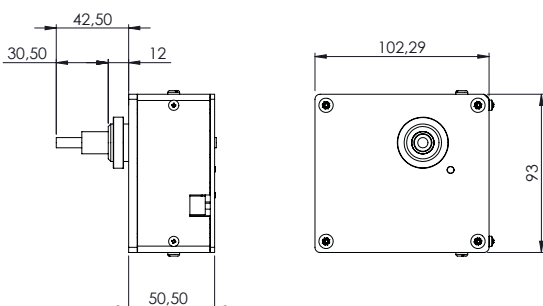

| CODE       | DESCRIPTION  |
|------------|--|
| RIC3504001 | SYNCHRONOUS CLOCK MOVEMENT MAX 130CM NO POWER RESERVE 220V |

## CLOCK MOVEMENTS W/O HAND SHAFT / MOUVEMENTS SANS MINUTERIE

RIC10-15-20-25

These clock movements w/o hand shaft are used for the movement of the clock hands of outdoor clocks installed on bell towers, municipal buildings, schools, railway stations etc. These devices (to be used in combination with one or more cog wheels) receive impulses from a master cock and transmit it to the clock hands every 60 seconds. Robustly constructed and with an enormous dragging power, they are able to control clock hands on dials between 0,9 and 10 m diameter (2,9 ft-32 ft).

Ces mouvements sans minuterie sont utilisés pour commander l'avance des aiguilles de cadrans installés sur les clochers, édifices scolaires et municipaux ou gares. Le récepteur (pour être utilisé en combinaison avec une ou plusieurs minuterie) reçoit l'impulsion d'une centrale horaire toutes les minutes et transmet l'avance aux aiguilles. De construction robuste et d'une grande puissance de transmission, les récepteurs font fonctionner les cadrans jusqu'à 10 m de diamètre.

### 4 OUTPUTS CLOCK MOVEMENT DIAL UP TO 90 CM – RIC10 MOUVEMENT POUR COMMANDE DE 4 CADRANS JUSQU'À 90 CM – RIC10



#### TECHNICAL CHARACTERISTICS

- To be used combined with one or more cog wheels
- Dial diameter: max 90 cm (2,9 ft)
- Outputs: 4
- Power: 220-230 VAC, 50/60 Hz, 9,5 W (RIC1004026); 115 VAC, 50/60 Hz, 3,5 W (RIC1004018)
- Torque: 2,94 Nm
- Functioning: minute inversion phase
- Stainless steel outputs (AISI 304)

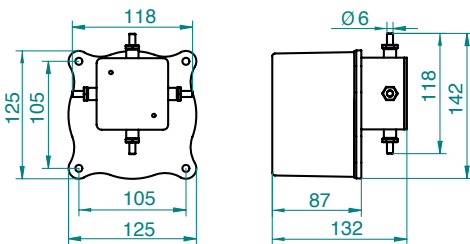

| CODE   | DESCRIPTION                                   |
|--|---|
| RIC1004018  | CLOCK MOVEMENT MAX 90CM PIN EXIT 4 EXITS 110V |
| RIC1004026   | CLOCK MOVEMENT MAX 90CM PIN EXIT 4 EXITS      |

### CLOCK MOVEMENT FOR DIAL UP TO 150 CM – RIC10 MOUVEMENT POUR COMMANDE DE CADRANS JUSQU'À 150 CM - RIC10



#### TECHNICAL CHARACTERISTICS

- To be used combined with one or more cog wheels
- Dial diameter: max 150 cm (4,9 ft)
- Power: 220-230 VAC, 50/60 Hz, 9,5 W
- Torque: 4,9 Nm
- Functioning: minute inversion phase
- Stainless steel outputs (AISI 304)

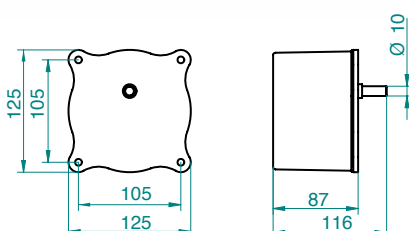

| CODE       | DESCRIPTION                       |
|------------|-----------------------------------|
| RIC1004001 | CLOCK MOVEMENT MAX 150CM PIN EXIT |

CLOCK MOVEMENT FOR DIAL UP TO 250 CM – RIC15  
MOUVEMENT POUR COMMANDE DE CADRANS JUSQU'À 250 CM – RIC15



TECHNICAL CHARACTERISTICS

- To be used combined with one or more cog wheels
- Dial diameter: max 250 cm (8,2 ft)
- Power: 220-230 VAC, 50 Hz, 16,7 W; 115 VAC, 60 Hz, 5 W
- Torque: 111,77 Nm
- Functioning: minute inversion phase
- Stainless steel outputs (AISI 304)

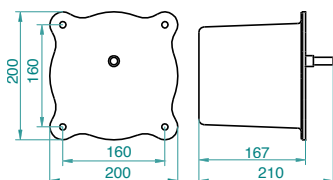

| CODE       | DESCRIPTION                       |
|------------|-----------------------------------|
| RIC1504001 | CLOCK MOVEMENT MAX 250CM PIN EXIT |

3/4 OUTPUTS CLOCK MOVEMENT DIAL UP TO 250 CM – RIC15  
MOUVEMENT POUR COMMANDE DE 3/4 CADRANS JUSQU'À 250 CM – RIC15



TECHNICAL CHARACTERISTICS

- To be used combined with one or more cog wheels
- Dial diameter: max 250 cm (8,2 ft)
- Outputs: 3/4
- Power: 220-230 VAC, 50 Hz, 16,7 W (RIC1504003-04); 115 VAC, 60 Hz, 5 W (RIC1504005)
- Torque: 11,7 Nm
- Functioning: minute inversion phase
- Stainless steel outputs (AISI 304)

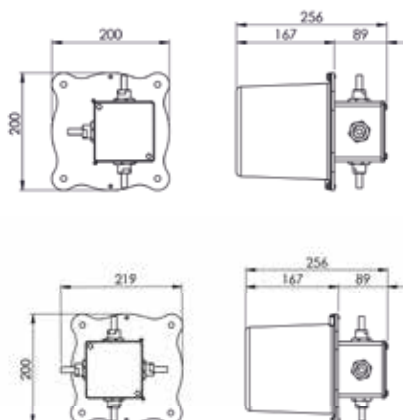

| CODE       | DESCRIPTION                                    |
|------------|--|
| RIC1504003 | CLOCK MOVEMENT MAX 250CM PIN EXIT 3 EXITS      |
| RIC1504004 | CLOCK MOVEMENT MAX 250CM PIN EXIT 4 EXITS      |
| RIC1504005 | CLOCK MOVEMENT MAX 250CM PIN EXIT 4 EXITS 110V |

CLOCK MOVEMENT FOR DIAL UP TO 400 CM – RIC20  
 MOUVEMENT POUR COMMANDE DE CADRANS JUSQU'À 400 CM – RIC20

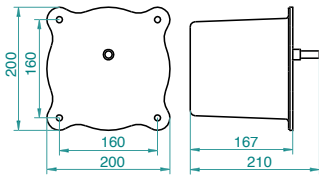

TECHNICAL CHARACTERISTICS

- Dial diameter: max 400 cm (13,1 ft)
- To be used combined with one or more cog wheels
- Power: 230 VAC, 50 Hz, 30 W; 115 VAC, 60 Hz, 29,7 W
- Torque: 29,4 Nm
- Functioning: minute inversion phase
- Stainless steel outputs (AISI 304)

| CODE       | DESCRIPTION                       |
|------------|-----------------------------------|
| RIC2004001 | CLOCK MOVEMENT MAX 400CM PIN EXIT |

3/4 OUTPUTS CLOCK MOVEMENT DIAL UP TO 400 CM – RIC20  
 MOUVEMENT POUR COMMANDE DE 3/4 CADRANS PARALLELES  
 JUSQU'À 400 CM – RIC20

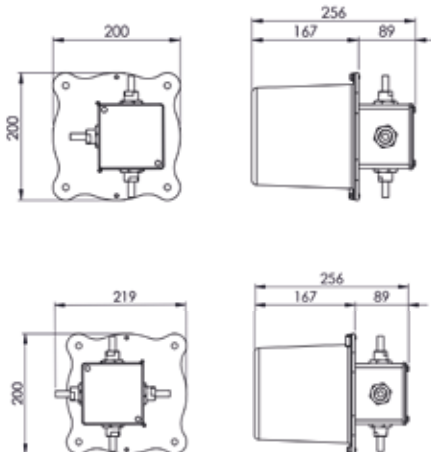

TECHNICAL CHARACTERISTICS

- To be used combined with one or more cog wheels
- Dial diameter: max 400 cm (13,1 ft)
- Outputs: 3/4
- Power: 230 VAC, 50 Hz, 30 W (RIC2004017-19);  
115 VAC, 60 Hz, 29,7 W (RIC2004023-26)
- Torque: 29,4 Nm
- Functioning: minute inversion phase
- Stainless steel outputs (AISI 304)

| CODE       | DESCRIPTION                                    |
|------------|--|
| RIC2004017 | CLOCK MOVEMENT MAX 400CM PIN EXIT 3 EXITS      |
| RIC2004019 | CLOCK MOVEMENT MAX 400CM PIN EXIT 4 EXITS      |
| RIC2004023 | CLOCK MOVEMENT MAX 400CM PIN EXIT 4 EXITS 110V |
| RIC2004026 | CLOCK MOVEMENT MAX 400CM PIN EXIT 3 EXITS 110V |

CLOCK MOVEMENT FOR DIAL MAX 1000 CM – RIC25  
MOUVEMENT POUR COMMANDE DE CADRANS MAX 1000 CM – RIC25

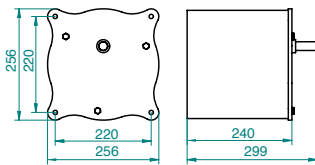

TECHNICAL CHARACTERISTICS

- To be used combined with one or more cog wheels
- Dial diameter: max 1000 cm (32,8 ft)
- Power: 220-230 VAC, 50/60 Hz, 25 W (RIC2504001);  
110-115 VAC, 60 Hz, 25 W (RIC2504003)
- Torque: 98 Nm
- Functioning: minute inversion phase
- Stainless steel outputs (AISI 304)

| CODE       | DESCRIPTION                             |
|------------|---|
| RIC2504001 | CLOCK MOVEMENT MAX 1000CM PIN EXIT      |
| RIC2504003 | CLOCK MOVEMENT MAX 1000CM PIN EXIT 110V |

4 OUTPUTS CLOCK MOVEMENT FOR DIAL MAX 800 CM – RIC25  
MOUVEMENT POUR COMMANDE DE 4 CADRANS MAX 800 CM – RIC25

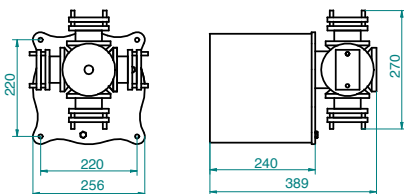

TECHNICAL CHARACTERISTICS

- To be used combined with one or more cog wheels
- Dial diameter: max 800 cm (26,2 ft)
- Outputs: 4
- Power: 220-230 VAC, 50/60 Hz, 25 W (RIC2504002);  
110-115 VAC, 60 Hz, 25 W (RIC2504004)
- Torque: 39,2 Nm
- Functioning: minute inversion phase
- Stainless steel outputs (AISI 304)

| CODE       | DESCRIPTION                                    |
|------------|--|
| RIC2504002 | CLOCK MOVEMENT MAX 800CM PIN EXIT 4 EXITS      |
| RIC2504004 | CLOCK MOVEMENT MAX 800CM PIN EXIT 4 EXITS 110V |



MINUTE HANDS COG WHEEL / MINUTERIES POUR CADRANS  
MIN05-10-15-20-30-35

MINUTE HANDS COG WHEEL FOR DIAL UP TO 90 CM – MIN05  
MINUTERIE POUR CADRANS JUSQU'À 90 CM – MIN05



TECHNICAL CHARACTERISTICS

- Wheels in brass
- Sprockets in brass
- Pin in steel
- Cog wheels with protective cover in aluminium
- For the command of clock dials up to 90 cm (2,9 ft) diameter
- It can be used with backlit dial
- Stainless steel outputs (AISI 304)

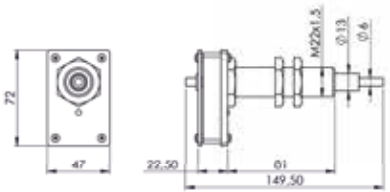

| CODE       | DESCRIPTION                                     |
|------------|---|
| MIN0504001 | MINUTE HANDS COG WHEEL MAX 90CM BUSH 76MM (3IN) |

MINUTE HANDS COG WHEEL FOR DIAL UP TO 150 CM – MIN10  
MINUTERIE POUR CADRANS JUSQU'À 150 CM – MIN10



TECHNICAL CHARACTERISTICS

- Wheels in brass
- Sprockets in brass
- Pin in steel
- Cog wheels with protective cover in aluminium
- For the command of clock dials up to 150 cm m (4,9 ft) diameter
- Stainless steel outputs (AISI 304)

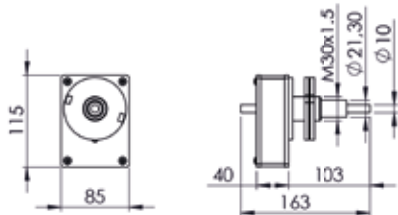

| CODE       | DESCRIPTION  |
|------------|--|
| MIN1004001 | MINUTE HANDS COG WHEEL MAX 150CM BUSH 35MM (1,4IN) |
| MIN1004002 | MINUTE HANDS COG WHEEL MAX 150CM BUSH 76MM (3IN)   |

MINUTE HANDS COG WHEEL / MINUTERIES POUR CADRANS  
MIN05-10-15-20-30-35

MINUTE HANDS COG WHEEL FOR DIAL UP TO 400 CM – MIN15  
MINUTERIE POUR CADRANS JUSQU'À 400 CM – MIN15

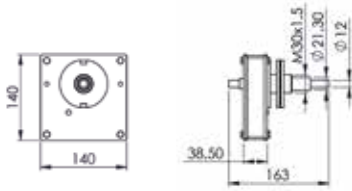

TECHNICAL CHARACTERISTICS

- Wheels in brass
- Sprockets in brass
- Pin in steel
- Cog wheels with protective cover in aluminium
- For the command of clock dials up to 400 cm (13,1 ft)
- Stainless steel outputs (AISI 304)

| CODE       | DESCRIPTION  |
|------------|--|
| MIN1504001 | MINUTE HANDS COG WHEEL MAX 400CM BUSH 35MM (1,4IN)           |
| MIN1504002 | MINUTE HANDS COG WHEEL MAX 400CM HOURS SHAFT 300MM (11,8IN)  |
| MIN1504003 | MINUTE HANDS COG WHEEL MAX 400CM HOURS SHAFT 600MM (23,6IN)  |
| MIN1504004 | MINUTE HANDS COG WHEEL MAX 400CM HOURS SHAFT 900MM (35,4IN)  |
| MIN1504005 | MINUTE HANDS COG WHEEL MAX 400CM HOURS SHAFT 1200MM (47,2IN) |
| MIN1504006 | MINUTE HANDS COG WHEEL MAX 400CM H. SHAFT ON REQUEST<1200MM  |
| MIN1504007 | MINUTE HANDS COG WHEEL MAX 400CM BUSH 76MM (3IN)             |
| MIN1504008 | MINUTE HANDS COG WHEEL MAX 400CM H. SHAFT 300MM (11,8IN) PRT |
| MIN1504009 | MINUTE HANDS COG WHEEL MAX 400CM H. SHAFT 600MM (23,6IN) PRT |
| MIN1504010 | MINUTE HANDS COG WHEEL MAX 400CM H. SHAFT 900MM (35,4IN) PRT |
| MIN1504011 | MINUTE HANDS COG WHEEL MAX 400CM H. SHAFT 1200MM (47,2IN)PRT |
| MIN1504012 | MINUTE HANDS COG WHEEL MAX 400CM H. SHAFT ON RQST<1200MM PRT |

MINUTE HANDS COG WHEEL FOR DIAL MAX 800 CM – MIN20  
MINUTERIE POUR CADRANS MAX 800 CM – MIN20

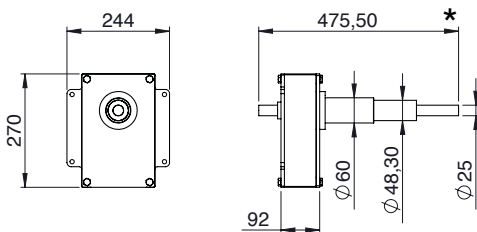

TECHNICAL CHARACTERISTICS

- Wheels in steel
- Sprockets in steel
- Protection tube in steel
- For the command of clock dials up to 800 cm (26,2 ft) diameter
- Customized length of output pin
- Stainless steel outputs (AISI 304)

| CODE       | DESCRIPTION   |
|------------|---|
| MIN2004001 | MINUTE HANDS COG WHEEL MAX 800CM H. SHAFT ON REQUEST<1200MM |

\* The drawing shows the minimum dimension of the cog wheel. Made-to-measure product.

MINUTE HANDS COG WHEEL / MINUTERIES POUR CADRANS  
MIN05-10-15-20-30-35

MINUTE HANDS COG WHEEL FOR FLORAL CLOCK – MIN30  
MINUTERIE POUR CADRANS DES HORLOGES FLORALES – MIN30

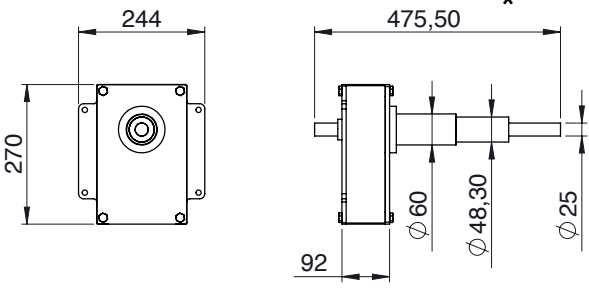

\* The drawing shows the minimum dimension of the cog wheel. Made-to-measure product.

Located at the entrance of a park or any public area, the floral clock allows you to decorate the city environment. This kind of clock is equipped with friction set on the outputs: in this way the clock hands can easily be released in the event of routine maintenance (eg. cutting grass). In addition, the cog wheel is mounted on thrust bearings which perform the function of supporting the hands clock.

Placée à l'entrée d'un parc ou dans n'importe qu'elle zone publique, l'horloge florale permet d'embellir l'environnement urbain. Ce genre d'horloge est caractérisé par un délicat et précis mécanisme intérieur, doté de frictions placées sur les commandes de sorties: de cette manière, l'aiguille peut être facilement enlevé en cas de maintenance de routine. De plus, la minuterie est montée sur des roulements qui supportent les aiguilles.

TECHNICAL CHARACTERISTICS

- Frictions for command dials up to 1000 cm (32,8 ft)
- Surface treatment zinc-nickel
- Stainless steel outputs (AISI 304)

A floral clock is made to customer specifications and it consists of:

- master clock
- clock movement (we recommend the RIC25 model)
- cog wheel

| CODE       | DESCRIPTION   |
|------------|---|
| MIN3004001 | MINUTE HANDS COG WHEEL MAX 1000 CM FOR FLORAL CLOCK |

1:24 MINUTE HANDS COG WHEEL FOR DIAL UP TO 400 CM – MIN35  
1:24 MINUTERIE POUR CADRANS MAX 400 CM – MIN35

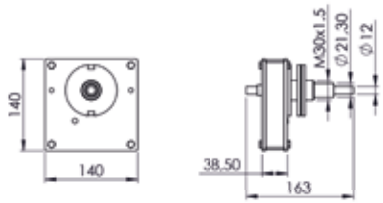

This kind of cog wheel is specifically designed to move the hands of 24-hour dials.

Ce genre de minuterie est expressément conçue pour faire fonctionner les aiguilles de cadrans 24 heures.

TECHNICAL CHARACTERISTICS

- Wheels in steel
- Sprockets in steel
- Pin in steel
- Cog wheels with protective cover in aluminium
- For the command of clock dials up to 400 cm (13,1 ft) diameter
- Stainless steel outputs (AISI 304)

| CODE       | DESCRIPTION   |
|------------|---|
| MIN3504001 | MINUTE HANDS COG WHEEL MAX 400CM BUSH 35MM (1,4IN) 1:24 |

## SECONDARY MOVEMENTS / MOUVEMENTS SECONDAIRES

### SEC05-10

Secondary movements with reversed polarity have two bushings: 4 and 24 mm; the latter is the ideal solution for thicker than usual clock faces and backlit ones. The 24-mm bushing resolves the aesthetic problem of shadows, guaranteeing uniform illumination of the clock face and excellent nocturnal readability.

Les mouvements secondaires à inversion de polarité sont dotés de deux typologies de pierre: de 4 et de 24 mm; cette dernière est la solution idéale pour des cadrans d'une épaisseur supérieure à la norme et pour des cadrans rétroéclairés. La pierre de 24 mm en effet permet de résoudre le problème esthétique des zones d'ombre, en garantissant une illumination uniforme du cadran et une lisibilité optimale dans l'obscurité.

### SECONDARY MOVEMENTS – SEC05

#### MOUVEMENT SECONDAIRE, PIERRE 4 MM – SEC05

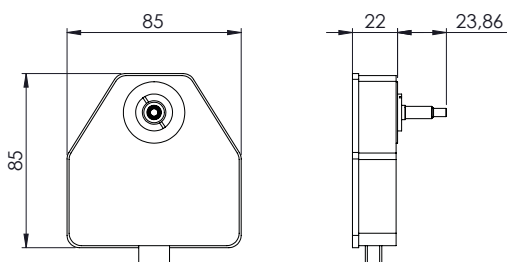

#### TECHNICAL CHARACTERISTICS

- Power: 10,8/12 VDC (SEC0504001); 24VDC (SEC0504002)
- Torque: 1,6 Ncm
- Functioning: reversed polarity

| CODE       | DESCRIPTION                                  |
|------------|--|
| SEC0504001 | SLAVE MOVEMENT 4MM BUSH (0,15IN) 10.8 /12VDC |
| SEC0504002 | SLAVE MOVEMENT 4MM BUSH (0,15IN) 24VDC       |

### SECONDARY MOVEMENTS – SEC05

#### MOUVEMENT SECONDAIRE, PIERRE 24 MM – SEC05

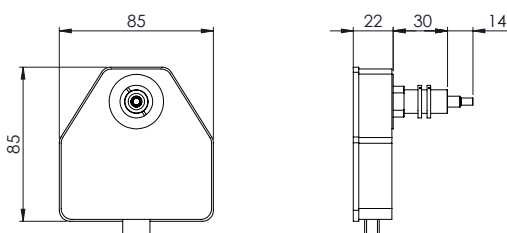

#### TECHNICAL CHARACTERISTICS

- Power: 10,8/12 VDC (SEC0504010); 24VDC (SEC0504011)
- Torque: 1,6 Ncm
- Functioning: reversed polarity

| CODE       | DESCRIPTION                                  |
|------------|--|
| SEC0504010 | SLAVE MOVEMENT 24MM BUSH (0,94IN) 10,8/12VDC |
| SEC0504011 | SLAVE MOVEMENT 24MM BUSH (0,94IN) 24VDC      |

SECONDARY MOVEMENTS – SEC05  
AUTOMATIC SET-UP – SEC05  
MOUVEMENT SECONDAIRE, PIERRE 4/24 MM  
AUTOMATIQUE SET-UP – SEC05



TECHNICAL CHARACTERISTICS

- Power: 10,8/12 VDC (SEC1004001); 24VDC (SEC1004010)
- Torque: 1,6 Ncm
- Functioning: reversed polarity
- To be used in conjunction with CLK35

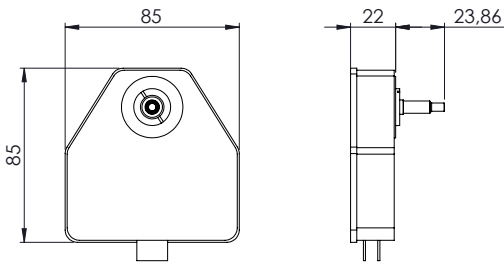

| CODE       | DESCRIPTION                                    |
|------------|--|
| SEC1004001 | SLAVE MOVEMENT 4MM BUSH (0,15IN) SELF SETTING  |
| SEC1004010 | SLAVE MOVEMENT 24MM BUSH (0,94IN) SELF SETTING |



## TABLE OF PRODUCT CODES

| CODE       | DESCRIPTION  |
|------------|--|
| RIC0504001 | CLOCK MOVEMENT MAX 90CM BUSH 25MM                            |
| RIC0504002 | CLOCK MOVEMENT MAX 90CM BUSH 76MM (3IN) 110V                 |
| RIC0504003 | CLOCK MOVEMENT MAX 90CM BUSH 76MM                            |
| RIC1004001 | CLOCK MOVEMENT MAX 150CM PIN EXIT                            |
| RIC1004003 | CLOCK MOVEMENT MAX 150CM BUSH 35MM                           |
| RIC1004004 | CLOCK MOVEMENT MAX 150CM BUSH 76MM (3IN) 110V                |
| RIC1004005 | CLOCK MOVEMENT MAX 150CM HOURS SHAFT 300MM                   |
| RIC1004006 | CLOCK MOVEMENT MAX 150CM HOURS SHAFT 300MM PRT               |
| RIC1004007 | CLOCK MOVEMENT MAX 150CM HOURS SHAFT 600MM                   |
| RIC1004008 | CLOCK MOVEMENT MAX 150CM HOURS SHAFT 600MM PRT               |
| RIC1004009 | CLOCK MOVEMENT MAX 150CM HOURS SHAFT 900MM                   |
| RIC1004010 | CLOCK MOVEMENT MAX 150CM HOURS SHAFT 900MM PRT               |
| RIC1004011 | CLOCK MOVEMENT MAX 150CM HOURS SHAFT 1200MM                  |
| RIC1004012 | CLOCK MOVEMENT MAX 150CM HOURS SHAFT 1200MM PRT              |
| RIC1004013 | CLOCK MOVEMENT MAX 150CM HOURS SHAFT ON REQUEST<1200MM       |
| RIC1004014 | CLOCK MOVEMENT MAX 150CM HOURS SHAFT ON REQUEST<1200MM PRT   |
| RIC1004015 | CLOCK MOVEMENT MAX 90CM BUSH 46MM (1.8IN) 2 EXITS 110V       |
| RIC1004016 | CLOCK MOVEMENT MAX 90CM BUSH 68MM (2.6IN) 2 EXITS 110V       |
| RIC1004017 | CLOCK MOVEMENT MAX 90CM BUSH 81MM (3.1IN) 2 EXITS 110V       |
| RIC1004018 | CLOCK MOVEMENT MAX 90CM PIN EXIT 4 EXITS 110V                |
| RIC1004019 | CLOCK MOVEMENT MAX 150CM BUSH 76MM                           |
| RIC1004020 | CLOCK MOVEMENT MAX 150CM BUSH 300MM (11.8IN) 110V            |
| RIC1004021 | CLOCK MOVEMENT MAX 150CM HOURS SHAFT 500 MM(19.6IN) 110V PRT |
| RIC1004022 | CLOCK MOVEMENT MAX 150CM BUSH 165MM (6.5IN) 110V             |
| RIC1004023 | CLOCK MOVEMENT MAX 90CM BUSH 46MM 2 EXITS                    |
| RIC1004024 | CLOCK MOVEMENT MAX 90CM BUSH 68MM 2 EXITS                    |
| RIC1004025 | CLOCK MOVEMENT MAX 90CM BUSH 81MM 2 EXITS                    |
| RIC1004026 | CLOCK MOVEMENT MAX 90CM PIN EXIT 4 EXITS                     |
| RIC1004027 | CLOCK MOVEMENT MAX 150CM H. SHAFT ON REQUEST<1200MM 110V PRT |
| RIC1504001 | CLOCK MOVEMENT MAX 250CM PIN EXIT                            |
| RIC1504003 | CLOCK MOVEMENT MAX 250CM PIN EXIT 3 EXITS                    |
| RIC1504004 | CLOCK MOVEMENT MAX 250CM PIN EXIT 4 EXITS                    |
| RIC1504005 | CLOCK MOVEMENT MAX 250CM PIN EXIT 4 EXITS 110V               |
| RIC2004001 | CLOCK MOVEMENT MAX 400CM PIN EXIT                            |
| RIC2004003 | CLOCK MOVEMENT MAX 400CM BUSH 35MM                           |
| RIC2004004 | CLOCK MOVEMENT MAX 400CM BUSH 76MM (3IN) 110V                |
| RIC2004005 | CLOCK MOVEMENT MAX 400CM HOURS SHAFT 300MM                   |
| RIC2004006 | CLOCK MOVEMENT MAX 400CM HOURS SHAFT 300MM PRT               |
| RIC2004007 | CLOCK MOVEMENT MAX 400CM HOURS SHAFT 600MM                   |
| RIC2004008 | CLOCK MOVEMENT MAX 400CM HOURS SHAFT 600MM PRT               |
| RIC2004009 | CLOCK MOVEMENT MAX 400CM HOURS SHAFT 500MM (19,6IN) PRT 110V |
| RIC2004010 | CLOCK MOVEMENT MAX 400CM HOURS SHAFT 900MM                   |
| RIC2004011 | CLOCK MOVEMENT MAX 400CM HOURS SHAFT 900MM PRT               |
| RIC2004012 | CLOCK MOVEMENT MAX 400CM HOURS SHAFT 1200MM                  |

## TABLE OF PRODUCT CODES

|            |  |
|------------|--|
| RIC2004013 | CLOCK MOVEMENT MAX 400CM HOURS SHAFT 1200MM PRT              |
| RIC2004014 | CLOCK MOVEMENT MAX 400CM HOURS SHAFT ON REQUEST<1200MM       |
| RIC2004015 | CLOCK MOVEMENT MAX 400CM HOURS SHAFT ON REQUEST<1200MM PRT   |
| RIC2004017 | CLOCK MOVEMENT MAX 400CM PIN EXIT 3 EXITS                    |
| RIC2004019 | CLOCK MOVEMENT MAX 400CM PIN EXIT 4 EXITS                    |
| RIC2004020 | CLOCK MOVEMENT MAX 400CM BUSH 300MM (11,8IN) 110V            |
| RIC2004021 | CLOCK MOVEMENT MAX 400CM BUSH 76MM                           |
| RIC2004022 | CLOCK MOVEMENT MAX 400CM BUSH 165MM (6,5IN) 110V             |
| RIC2004023 | CLOCK MOVEMENT MAX 400CM PIN EXIT 4 EXITS 110V               |
| RIC2004024 | CLOCK MOVEMENT MAX 400CM H. SHAFT ON REQUEST<1200MM 110V PRT |
| RIC2004026 | CLOCK MOVEMENT MAX 400CM PIN EXIT 3 EXITS 110V               |
| RIC2504001 | CLOCK MOVEMENT MAX 1000CM PIN EXIT                           |
| RIC2504002 | CLOCK MOVEMENT MAX 800CM PIN EXIT 4 EXITS                    |
| RIC2504003 | CLOCK MOVEMENT MAX 1000CM PIN EXIT 110V                      |
| RIC2504004 | CLOCK MOVEMENT MAX 800CM PIN EXIT 4 EXITS 110V               |
| RIC3004001 | CLOCK MOVEMENT MAX 300CM FOR ILLUMINATED HANDS DIAL          |
| RIC3004003 | CLOCK MOVEMENT MAX 300CM FOR ILLUMINATED HANDS DIAL - RGB    |
| RIC3504001 | SYNCHRONOUS CLOCK MOVEMENT MAX 130CM NO POWER RESERVE 220V   |
| MIN0504001 | MINUTE HANDS COG WHEEL MAX 90CM BUSH 76MM (3IN)              |
| MIN1004001 | MINUTE HANDS COG WHEEL MAX 150CM BUSH 35MM (1,4IN)           |
| MIN1004002 | MINUTE HANDS COG WHEEL MAX 150CM BUSH 76MM (3IN)             |
| MIN1504001 | MINUTE HANDS COG WHEEL MAX 400CM BUSH 35MM (1,4IN)           |
| MIN1504002 | MINUTE HANDS COG WHEEL MAX 400CM HOURS SHAFT 300MM (11,8IN)  |
| MIN1504003 | MINUTE HANDS COG WHEEL MAX 400CM HOURS SHAFT 600MM (23,6IN)  |
| MIN1504004 | MINUTE HANDS COG WHEEL MAX 400CM HOURS SHAFT 900MM (35,4IN)  |
| MIN1504005 | MINUTE HANDS COG WHEEL MAX 400CM HOURS SHAFT 1200MM (47,2IN) |
| MIN1504006 | MINUTE HANDS COG WHEEL MAX 400CM H. SHAFT ON REQUEST<1200MM  |
| MIN1504007 | MINUTE HANDS COG WHEEL MAX 400CM BUSH 76MM (3IN)             |
| MIN1504008 | MINUTE HANDS COG WHEEL MAX 400CM H. SHAFT 300MM (11,8IN) PRT |
| MIN1504009 | MINUTE HANDS COG WHEEL MAX 400CM H. SHAFT 600MM (23,6IN) PRT |
| MIN1504010 | MINUTE HANDS COG WHEEL MAX 400CM H. SHAFT 900MM (35,4IN) PRT |
| MIN1504011 | MINUTE HANDS COG WHEEL MAX 400CM H. SHAFT 1200MM (47,2IN)PRT |
| MIN1504012 | MINUTE HANDS COG WHEEL MAX 400CM H. SHAFT ON RQST<1200MM PRT |
| MIN2004001 | MINUTE HANDS COG WHEEL MAX 800CM H. SHAFT ON REQUEST<1200MM  |
| MIN3004001 | MINUTE HANDS COG WHEEL MAX 1000 CM FOR FLORAL CLOCK          |
| MIN3504001 | MINUTE HANDS COG WHEEL MAX 400CM BUSH 35MM (1,4IN) 1:24      |
| SEC0504001 | SLAVE MOVEMENT 4MM BUSH (0,15IN) 10.8 /12VDC                 |
| SEC0504002 | SLAVE MOVEMENT 4MM BUSH (0,15IN) 24VDC                       |
| SEC0504010 | SLAVE MOVEMENT 24MM BUSH (0,94IN) 10,8/12VDC                 |
| SEC0504011 | SLAVE MOVEMENT 24MM BUSH (0,94IN) 24VDC                      |
| SEC1004001 | SLAVE MOVEMENT 4MM BUSH (0,15IN) SELF SETTING                |
| SEC1004010 | SLAVE MOVEMENT 24MM BUSH (0,94IN) SELF SETTING               |

## TABLE OF PRODUCT CODES

ACCESSORIES

|            |   |
|------------|---|
| FIL0504002 | RC ADDITIONAL FILTER FOR CLOCK MOTOR 10-15-20-25        |
| LAN9504001 | BUSH FOR DIAL HANDS RIC05                               |
| LAN9504002 | BUSH FOR DIAL HANDS RIC10                               |
| LAN9504003 | BUSH FOR DIAL HANDS RIC20                               |
| LAN9504004 | BUSH FOR DIAL HANDS SEC05-10                            |
| MIN8504001 | ANGLE ATTACHMENT FOR CLOCK HANDS MOTOR 90 DEGREES       |
| MIN8504002 | UNIVERSAL JOINT IN BRASS DIAMETER 10/10 MM              |
| MIN8504003 | ARTICULATED BRASS ATTACHMENT 10/10MM                    |
| MIN8504004 | ARTICULATED BRASS ATTACHMENT 6/6 MM                     |
| MIN8504005 | UNIVERSAL JOINT IN BRASS 10/12MM                        |
| MIN8504006 | UNIVERSAL JOINT IN BRASS 12/12MM                        |
| MIN8504010 | ARTICULATED JOINT IN BRASS 10/12MM                      |
| MIN8504011 | ARTICULATED JOINT IN BRASS 12/12MM                      |
| MIN8504020 | UNIVERSAL JOINT IN GALVANIZED STEEL 10/10MM             |
| MIN8504021 | UNIVERSAL JOINT IN GALVANIZED STEEL 10/12MM             |
| MIN8504022 | UNIVERSAL JOINT IN GALVANIZED STEEL 12/12MM             |
| RIC8504001 | MOUNTING BRACKET FOR RIC20                              |
| RIC8504002 | MOUNTING BRACKET FOR RIC25                              |
| RIC8504003 | FIXING RING NUT FOR RIC10-20-MIN15 WITH PROTECTIVE TUBE |
| RIC8504004 | CENTRAL SUPPORT BRACKET FOR RIC10-20-MIN15              |

TABLE OF PRODUCT CODES

CLOCK HANDS MOVEMENT / MOUVEMENT DES AIGUILLES